

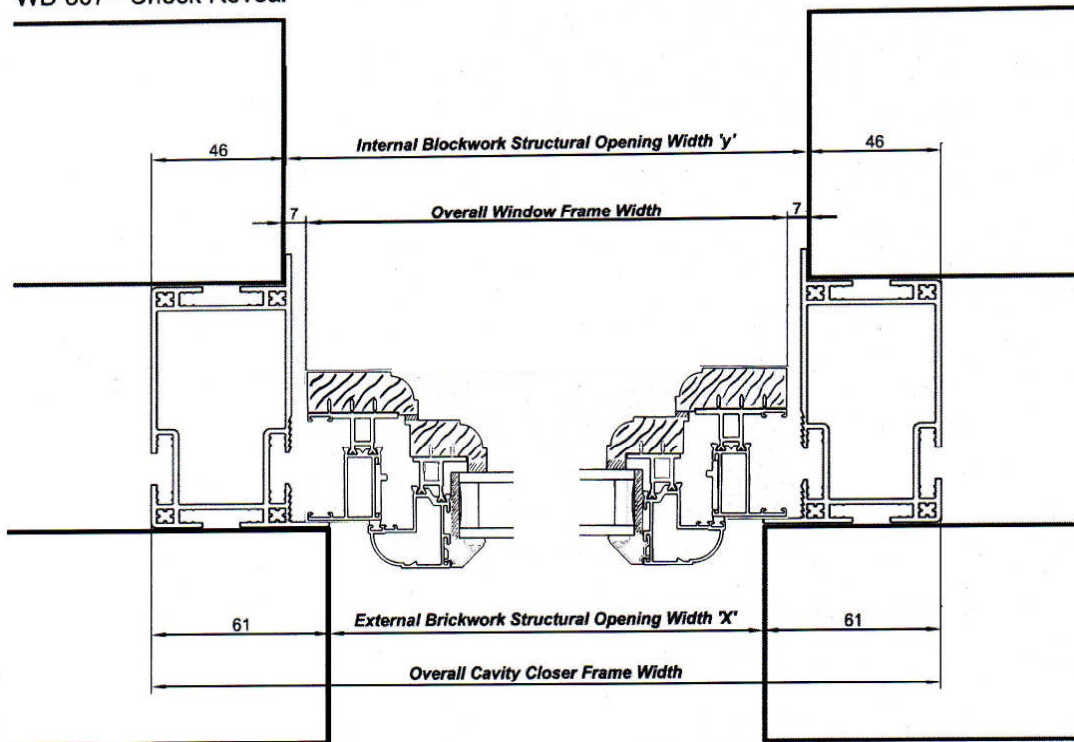

## Franklin Cavity Tray Detail for internal fit/incheck installation

WD 807 - Check Reveal



Moulded Corner Cavity Closer Width = External Brickwork Structural Opening Width 'X' + 26mm

Moulded Corner Cavity Closer Width = Internal Blockwork Structural Opening Width 'Y' - 4mm

Welded Corner Cavity Closer Width = External Brickwork Structural Opening Width 'X' + 122mm + Welding Allowance

Welded Corner Cavity Closer Width = Internal Blockwork Structural Opening Width 'Y' + 92mm + Welding Allowance

Overall Window Frame Width = External Brickwork Structural Opening Width 'X' + 16mm

Overall Window Frame Width = Internal Blockwork Structural Opening Width 'Y' - 14mm

### Weld Allowance

Weld Allowance is a variable and may differ for each welder. It is determined by mitring two pieces of profile at 500mm long, and using the profile support blocks, welding the two profiles together to form a corner and measuring the length of the corner when it has cooled. The difference between the 500mm cut length and the welded length is half the TOTAL WELD ALLOWANCE. Therefore when manufacturing frames the TOTAL WELD ALLOWANCE must be added to the cutting sizes or breakdowns prior to cutting.

Carlton Works, Cemetery Road, Yeadon, Leeds, LS19 7BD. Tel: 0113 2502991 Fax: 0113 2500991  
<http://www.franklinconservatories.com> e-mail, [sales@franklinconservatories.com](mailto:sales@franklinconservatories.com)